

**architrave
and skirting**

architrave and skirting

Why not complete your home with the perfect finish for interiors by decorating your doors, windows, flooring, walls and staircases.

Corinthian Doors have skirting and architrave designs to suit any architecture period from the traditional colonial to the sleek and contemporary half splayed profile.

Moisture resistant and pre-primed for a smooth paint finish.

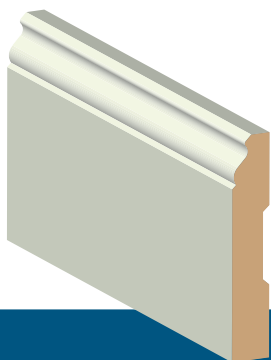

Australian Colonial

MATERIAL: Primed MDF
SIZE: 67x12

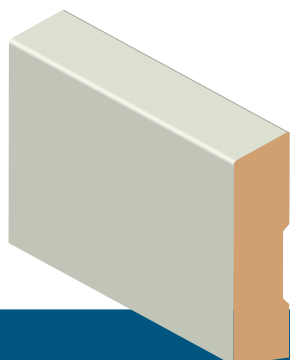

Bevelled

MATERIAL: Primed MDF
SIZE: 42x12, 67x12

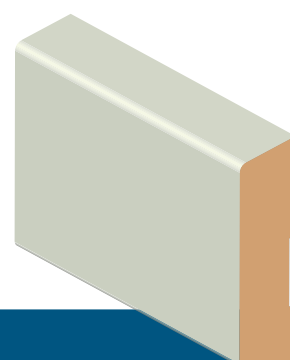

SA Bevelled

MATERIAL: Primed MDF
SIZE: 67x18, 92x18

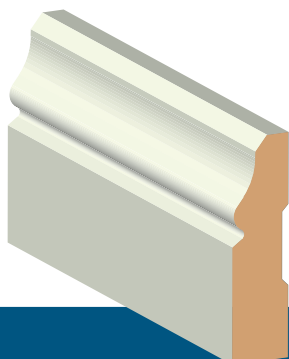

Colonial

MATERIAL: Primed MDF
SIZE: 67x18, 92x18, 140x18



Double Pencil Round

MATERIAL: Primed MDF
SIZE: 42x12, 67x12, 92x12

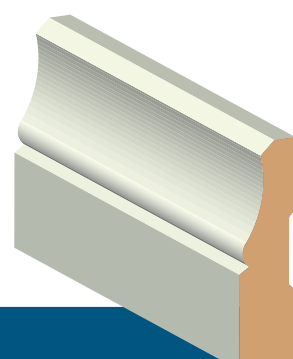

Lambs Tongue

MATERIAL: Primed MDF
SIZE: 42x12, 67x12

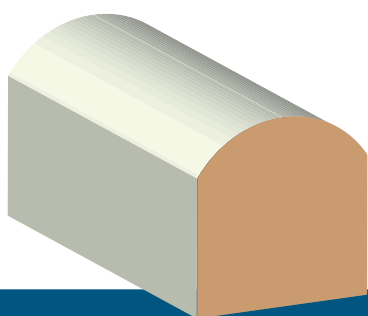

Nosing

MATERIAL: Primed MDF
SIZE: 190x30

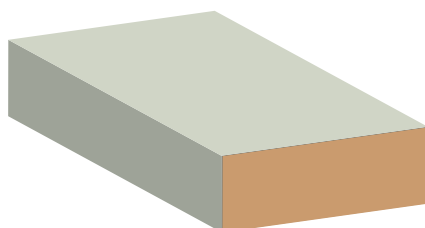

Square Dressed

MATERIAL: Primed MDF
SIZE: 30x12, 75x12, 67x18, 92x18, 100x18, 110x18, 140x18, 194x18, 140x30

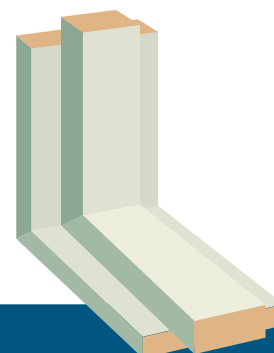

Door Jamb sets

MATERIAL: Primed MDF
SIZE: 92x18, 98x18, 112x18, 112x30, 98x30

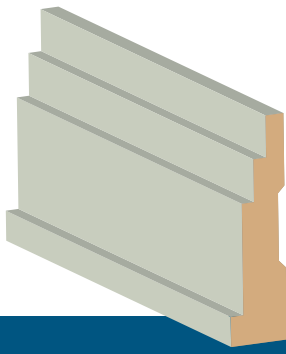

Deco

MATERIAL: Primed MDF

SIZE: 67x18, 85x18, 135x18

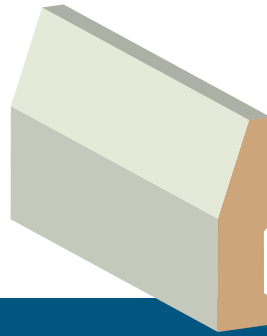

Half Splayed

MATERIAL: Primed MDF

SIZE: 67x18, 92x18, 140x18

timber species definitions

Material	Origin	Colour	Technical
MDF	Medium Density Fibreboard is an engineered timber product formed by the breaking down of softwood and woodchips into wood fibres similar to cotton wool, combining it with a wax and resin binder. Panels are then formed by applying high temperature and pressure. The panels have smooth surfaces on both sides and have an even density profile throughout which makes an ideal substrate to router, groove and profile.	Yellow to brown in colour with a smooth texture.	<p>Primed MDF: The MDF architrave is coated with a primer sealant to make painting easier and help achieve a smooth finish.</p> <p>Moisture Resistant: Our Primed MDF architraves meet the highest Australian standards for moisture resistance.</p>





CORINTHIAN DOORS

A JELD-WEN Company



Corinthian Doors are available
from over 2,500 resellers
nationally visit our website:
corinthian.com.au
or call Corinthian for your
nearest stockist.

SHOWROOMS

ADELAIDE

Regency Park

38 Birralee Road
(08) 8243 0888



JELD-WEN
AUSTRALIA

CORINTHIAN INDUSTRIES (AUSTRALIA) PTY LIMITED

© Copyright reserved 2016 Corinthian Doors
JWCSA0112/0216